



SALE NEW

# maiora 30 walkaround

## Description

### Maiora 30

It is the latest work of the Maiora house, with its 2 man 2000 hp and its water lines it has its maximum efficiency in terms of consumption at displacement with a range of 1,100 NM at 10 knots. A cruising speed of 18 knots and a maximum speed of 24 knots.

One of the peculiarities of this unit is the flybridge area is walkaround with more than 100 square meters of open space; You have the possibility to reach your own area very easily on a single floor.

Also excellent is the choice to obtain an additional garage with crane in the bow for 2 jet skis

And towards the west, on the port side there is the retractable garage for the tender

Guests up to 12 in 5 cabins

Crew 5 in 3 cabins

Staging and technical:

Stabilizers (zero speed & underway electrical fin stabilizers).

Accessories notes:

Max speed 22 knots

Cruising Speed 18 knots

## Specifications

YEAR

2024

WIDTH

7.50

FUEL TANK CAPACITY

13000

BATHROOMS

1

HORSE POWER

2 X 2000 CV

LENGTH

30.50

DRAFT

1.90

CABINS

4

ENGINE MANUFACTURER

MAN V12-2000

**General**

---

TYPE	BRAND	MODEL	CURRENT LOCATION
Motorboat	maiora	30 walkaround	Toscana

**Dimensions / Performance**

---

FUEL CAPACITY (L)	CRUISING SPEED (ND)	TOP SPEED (ND)
13000	18	22

**Building / facilities**

---

AMOUNT OF CABINS	BERTHS	BATHROOM(S)
4	8	1

**Engine room**

---

ENGINE	NUMBER OF ENGINES HORSE POWER (CV)	FUEL
MAN V12-2000	2 x 2000	Diesel

**Deck equipment**

---

DECK SHOWER

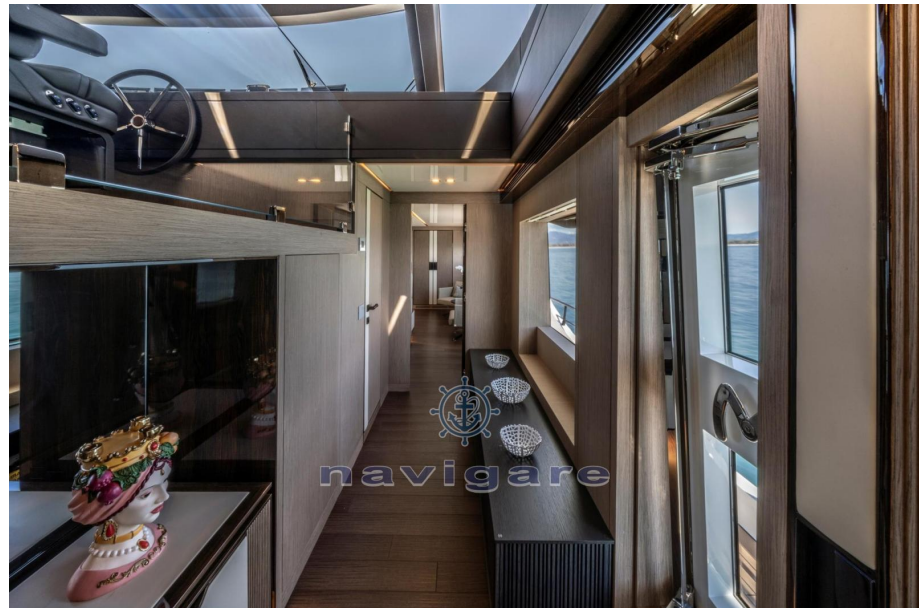



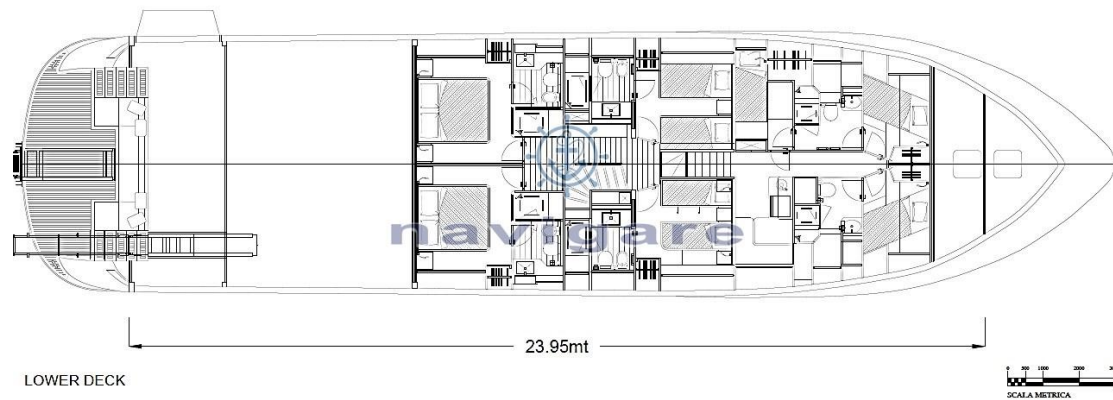
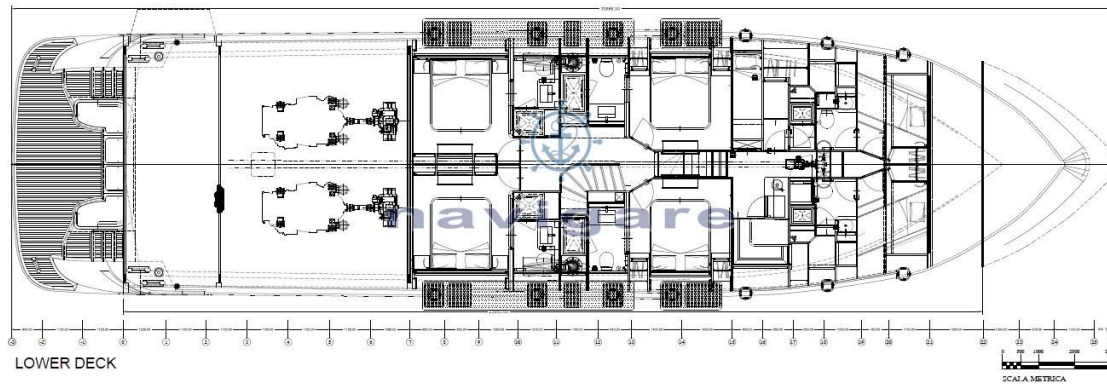
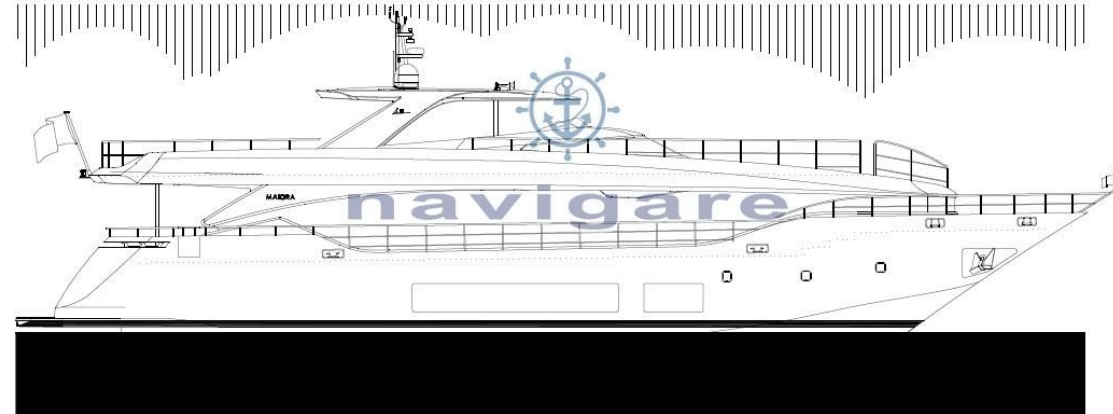

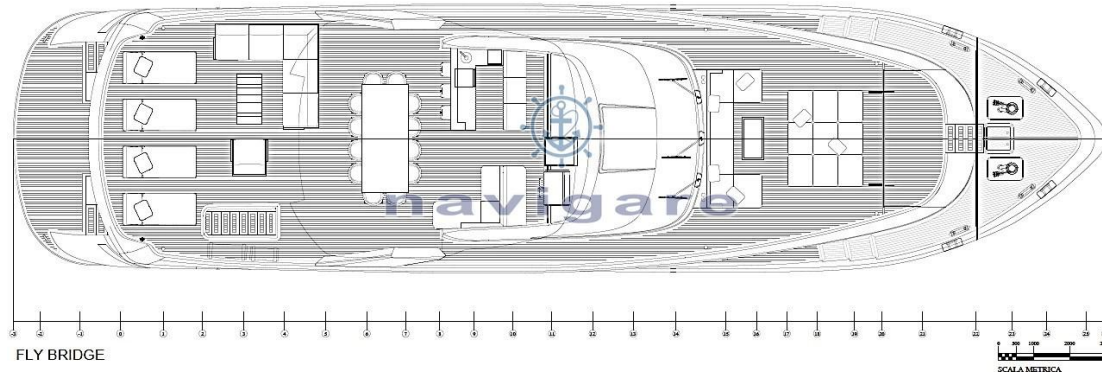

FLY BRIDGE

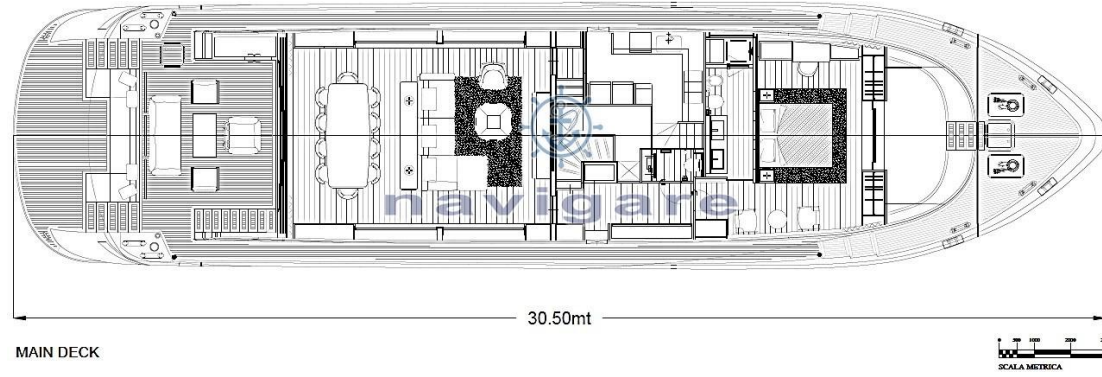

MAIN DECK

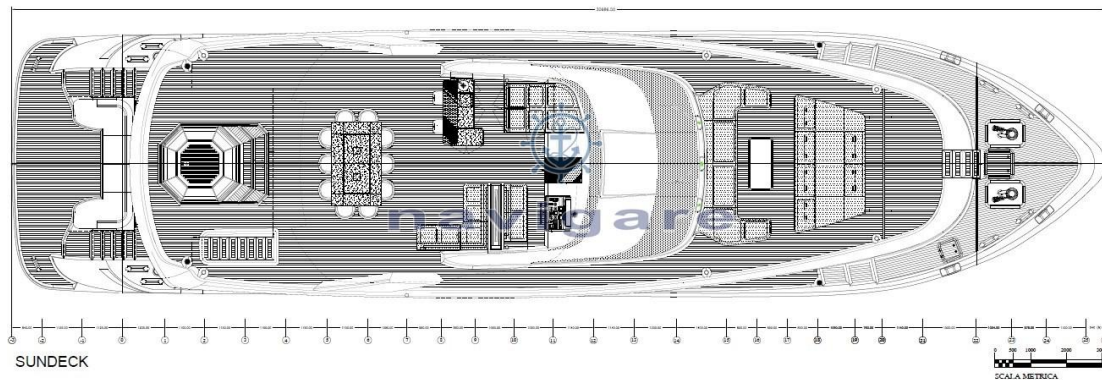

SUNDECK

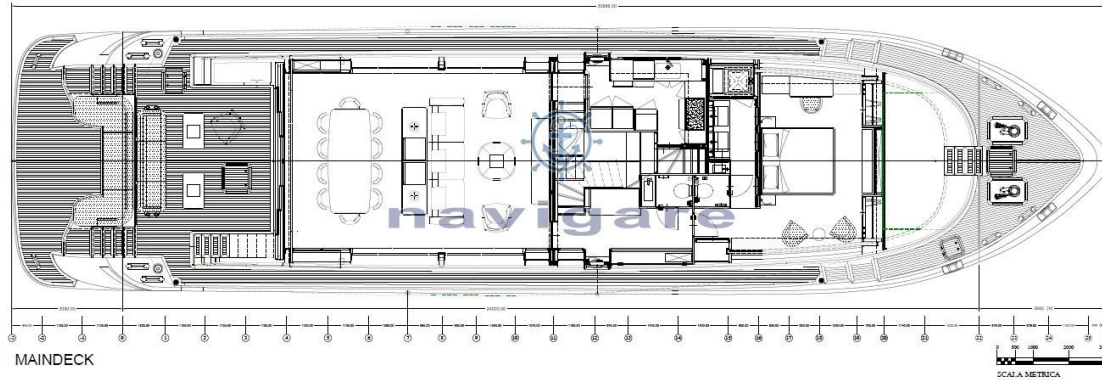

MAINDECK

