



SALE PRE OWNED

**toy marine Toy 68**

**1 250 000 € All Tax Included**

## Description

Sole Owner, Vat paid. Great conditions.

2022/23: Full Paint Hull + Superstructure, Interior Woodwork Repaint (Great Job!).

2023/24 Engines Overhaul.

She's just Ready to go

Navigation equipment:

On-Board Computer, Radar (48M), VHF Radio (con Dsc e Gps asservito).

Staging and technical:

2 Engine Alarm, Bilge Alarm, Water pressure pump, Special Colour, Deck Shower, Twin Steering, Hydraulic Flaps, Courtesy Lights, Gangway (elettroidraulica), Platform (con piano in teak), 5 Automatic Bilge Pump, Entry door, Teak Cockpit, Shorepower connector, Voltage Rectifier, Electric Windlass, swimming ladder, Horn.

Domestic Facilities onboard:

Warm Water System (bivalente), Inverter Air Conditioning, 12V Outlets, 220V Outlets, 4 Electric Toilet.

Entertainment:

Speakers, DTV, Hi-Fi.

Kitchen and appliances:

## Specifications

YEAR

2010

WIDTH

5.30

FUEL TANK CAPACITY

6700

CABINS

3

ENGINE MANUFACTURER

Caterpillar C18

HORSE POWER

2 X 1015 CV

LENGTH

20.46

DRAFT

1.30

GUESTS CRUISING

16

BATHROOMS

1

ENGINE HOURS

1520

## General

TYPE	BRAND	MODEL	GUESTS CRUISING
Motorboat	toy marine	Toy 68	16

## Dimensions / Performance

WEIGHT (T)	FUEL CAPACITY (L)	CRUISING SPEED (ND)	TOP SPEED (ND)
9999.99	6700	26	30

## Building / facilities

HULL MATERIAL	HULL COLOR	DECK MATERIAL	AMOUNT OF CABINS
Vetroresina	Blue	TEAK	3
BERTHS	BATHROOM(S)		
6	1		

## Engine room

ENGINE	NUMBER OF ENGINES HORSE POWER (CV)	ENGINE HOURS	PROPULSION
Caterpillar C18	2 x 1015	1520	5 pale
FUEL	BOW THRUSTER		
Diesel			

## Electricity / air conditioning

ENGINE BATTERY	BATTERY CHARGER	GENERATOR	AIR CONDITIONING

### **Navigation equipment**

---

TRACER	RADAR	AUTO PILOT	VHF
NAVIGATION COMPASS	SONAR	SPEEDOMETER	ANCHOR
FLYBRIDGE			

### **Galley / Laundry / Entertainment**

---

FREEZER	FRIDGE	TV
---------	--------	----

### **Deck equipment**

---

DECK SHOWER

### **Safety equipment / miscellaneous**

---

BILGE PUMP





















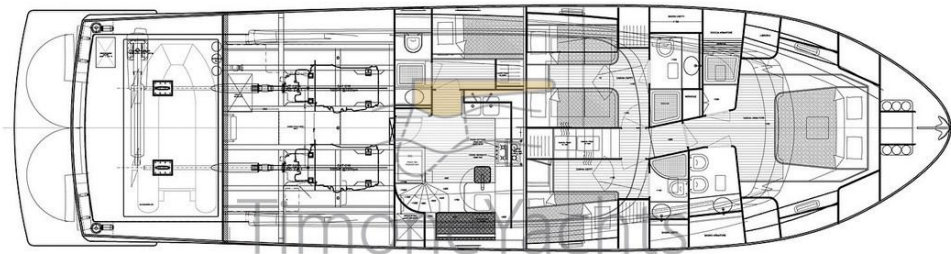

SINCE 1984