



SALE PRE OWNED

dalla pieta Dp 48 altair open

Description

CHARMING AND ELEGANT. EXCELLENT CONSTRUCTION QUALITY. A TIMELESS SPORTS CAR.

Convivial outside; Ideal for sunbathing and wind on the skin.

Inside a real marine cabin cruiser for long cruises in comfort and luxurious comfort.

Charming fine wood finishes, a classic nautical style.

Manically held

Navigation equipment:

Radar Antenna (Raymarine), Intercom, Autopilot (Raymarine), Plotter with GPS antenna (Raymarine touch 12" multifunzione: radar ecoscandaglio).

Staging and technical:

Teak Side Decks, Hydraulic Flaps, Tender Garage, Underwater lights, Teak Cockpit.

Domestic Facilities onboard:

Inverter Air Conditioning.

Security equipment:

Safety equipment within 6 miles.

Entertainment:

DTV.

Specifications

YEAR

2003

WIDTH

4.15

CABINS

3

ENGINE MANUFACTURER

Caterpillar 3196

HORSE POWER

2 X 660 CV

LENGTH

14.90

GUESTS CRUISING

12

BATHROOMS

1

ENGINE HOURS

800

General

TYPE	BRAND	MODEL	GUESTS CRUISING
Motorboat	dalla pieta	Dp 48 altair open	12
CURRENT LOCATION	Veneto, mare adriatico		

Dimensions / Performance

WEIGHT (T)
9999.99

Building / facilities

HULL MATERIAL	AMOUNT OF CABINS	BERTHS	BATHROOM(S)
Vetroresina	3	6	1

Engine room

ENGINE	NUMBER OF ENGINES HORSE POWER (CV)	ENGINE HOURS	FUEL
Caterpillar 3196	2 x 660	800	Diesel
STERN THRUSTER	BOW THRUSTER		

Electricity / air conditioning

GENERATOR	AIR CONDITIONING
-----------	------------------

Navigation equipment

AUTO PILOT

VHF

Galley / Laundry / Entertainment

FRIDGE

Deck equipment

CANOPY







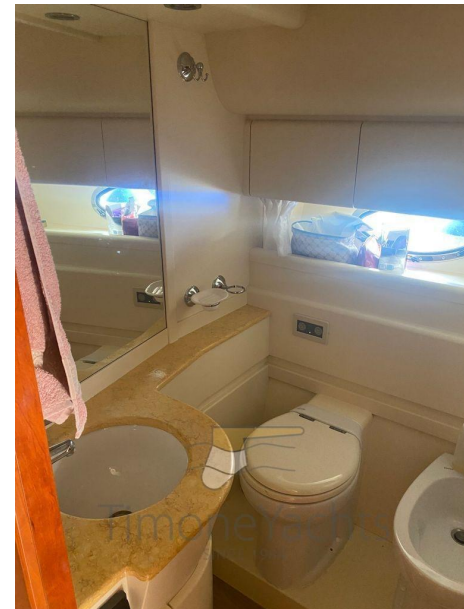

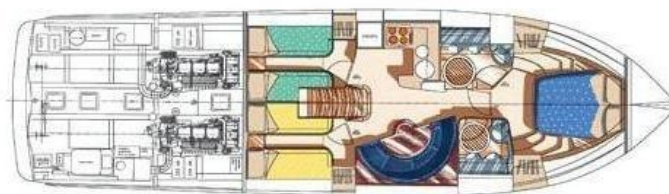

TimoneYachts
SINCE 1984