



SALE PRE OWNED

dalla pieta Dp 72

1 090 000 € All Tax Included

Description

Dalla Pietà 72 is the epitome of luxury and sophistication, combining powerful performance with elegant design. This luxury motor yacht, characterised by strong straight lines and a sporty profile, is as impressive in style as she is in functionality.

Whether you are hosting a gathering or simply unwinding, Dalla Pietà 72 provides ample space and versatility. The aft deck is ideal for alfresco dining and lounging, while the bow seating area offers a serene spot to enjoy the views and sunshine. The spacious saloon inside and dining areas are a sophisticated space perfect for socialising, entertaining or relaxing, offering a stylish and inviting atmosphere featuring contemporary furnishings and a seamless design.

In the lower deck you will be greeted by an interior that comfortably accommodates 8 guests within 4 modern and sumptuous cabins. Each cabin is designed to provide the utmost comfort and luxury, ensuring guests enjoy a restful and indulgent stay.

From the powerful, sporty design to the luxurious amenities, every detail of this Dalla Pietà 72 is crafted to provide an exceptional yachting experience. The combination of sleek exterior lines and sumptuous interior spaces makes this yacht a true standout.

This yacht is in Turn Key condition, with several upgrades and maintenance works carried out in the last year. This ensures that every aspect of this yacht is in pristine condition, ready for you to step aboard and start your adventure without any worries.

Specifications

YEAR

2008

WIDTH

5.72

FUEL TANK CAPACITY

5000

CABINS

4

ENGINE MANUFACTURER

Caterpillar C32

HORSE POWER

2 X 1670 CV

LENGTH

22.35

DRAFT

1.89

GUESTS CRUISING

16

BATHROOMS

1

ENGINE HOURS

960

General

| | | | |
|------------------|-------------|-------|-----------------|
| TYPE | BRAND | MODEL | GUESTS CRUISING |
| Motorboat | dalla pieta | Dp 72 | 16 |
| CURRENT LOCATION | Venezia | | |

Dimensions / Performance

| | | | |
|------------|-------------------|---------------------|----------------|
| WEIGHT (T) | FUEL CAPACITY (L) | CRUISING SPEED (ND) | TOP SPEED (ND) |
| 9999.99 | 5000 | 27 | 33 |

Building / facilities

| | | | |
|---------------|------------------|--------|-------------|
| HULL MATERIAL | AMOUNT OF CABINS | BERTHS | BATHROOM(S) |
| Vetroresina | 4 | 8 | 1 |

Engine room

| | | | |
|-----------------|------------------------------------|--------------|----------------|
| ENGINE | NUMBER OF ENGINES HORSE POWER (CV) | ENGINE HOURS | STERN THRUSTER |
| Caterpillar C32 | 2 x 1670 | 960 | |
| BOW THRUSTER | | | |

Electricity / air conditioning

ENGINE BATTERY

BATTERY
CHARGER

GENERATOR

AIR CONDITIONING

HEATING SYSTEM

Navigation equipment

GPS

AUTO PILOT

VHF

NAVIGATION COMPASS

SONAR

SPEEDOMETER

ANCHOR

Galley / Laundry / Entertainment

OVEN

FREEZER

FRIDGE

TV

Deck equipment

DECK SHOWER

Safety equipment / miscellaneous

LIFE
RAFT

BILGE PUMP











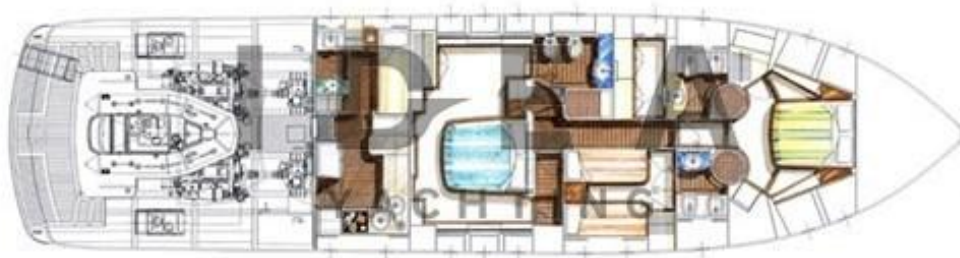

Lower Deck - 3 cabins