



SALE NEW

de cesari Dc 62

2 200 000 € All Tax Included

Description

From the pencil of Giovanni Ceccarelli (leader in the field of yacht design in Italy and in the world, thanks also to his ability to combine tradition and innovation and his vast experience he has created boats among the most performing and appreciated all over the world) and from the axe of Paolo De Cesari (established in the world for the construction of exclusive and unique yachts thanks to his ability to combine tradition and innovation, the unique in Italy and one of the few in Europe capable of building prototypes of large yachts), this fantastic project was born, destined to become an icon of world boating: the DE CESARI 62.

The De Cesari 62 is a 19-metre overall motoryacht that stands out for its classic lines and timeless elegance. Currently in an advanced stage of construction at the De Cesari Shipyard in Cervia, under the guidance of Paolo De Cesari, this yacht represents a perfect combination of tradition and innovation.

Notable features:

Semi-planing hull with classic and slender lines, Inverted stern and deep V round hull with variable geometry for excellent seakeeping and course stability, Design speed of 23 knots and cruising speed of 18 knots, Inboard engine of 2x730 hp, Shaft line propulsion with 4-blade propeller, Spacious and comfortable interiors on two levels, Owner's cabin in the bow and two guest cabins, all with independent bathrooms, Crew cabin with separate access, Classic interior style with furniture made on site, Large cockpit that can be used for fishing or cruising, Flybridge equipped for comfortable cruising and equipped with tender with hydraulic davit,

Specifications

YEAR

2024

WIDTH

5.45

FUEL TANK CAPACITY

2800

CABINS

3

ENGINE MANUFACTURER

MAN I6 730

HORSE POWER

2 X 730 CV

LENGTH

19.00

DRAFT

1.50

GUESTS CRUISING

10

BATHROOMS

1

ENGINE HOURS

1

General

TYPE	BRAND	MODEL	GUESTS CRUISING
Motorboat	de cesari	Dc 62	10
CURRENT LOCATION	Emilia, italia		

Dimensions / Performance

WEIGHT (T)	FUEL CAPACITY (L)	CRUISING SPEED (ND)	TOP SPEED (ND)
9999.99	2800	16	24

Building / facilities

HULL MATERIAL	SUPER STRUCTURE MATERIAL	DECK MATERIAL	AMOUNT OF CABINS
Mogano	Mogano	TEAK	3
BERTHS	BATHROOM(S)		
6	1		

Engine room

ENGINE	NUMBER OF ENGINES HORSE POWER (CV)	ENGINE HOURS	PROPULSION
MAN I6 730	2 x 730	1	Pale fisse
FUEL	BOW THRUSTER		
Diesel			

Electricity / air conditioning

ENGINE BATTERY

BATTERY
CHARGER

GENERATOR

AIR CONDITIONING

HEATING SYSTEM

Navigation equipment

GPS

TRACER

RADAR

AUTO PILOT

VHF

NAVIGATION COMPASS

SONAR

SPEEDOMETER

ANCHOR

Galley / Laundry / Entertainment

OVEN

MICROWAVE

FREEZER

FRIDGE

TV

DVD PLAYER

Deck equipment

DECK SHOWER

BIMINI

CANOPY

Safety equipment / miscellaneous

EPIRB

LIFE
RAFT

BILGE PUMP







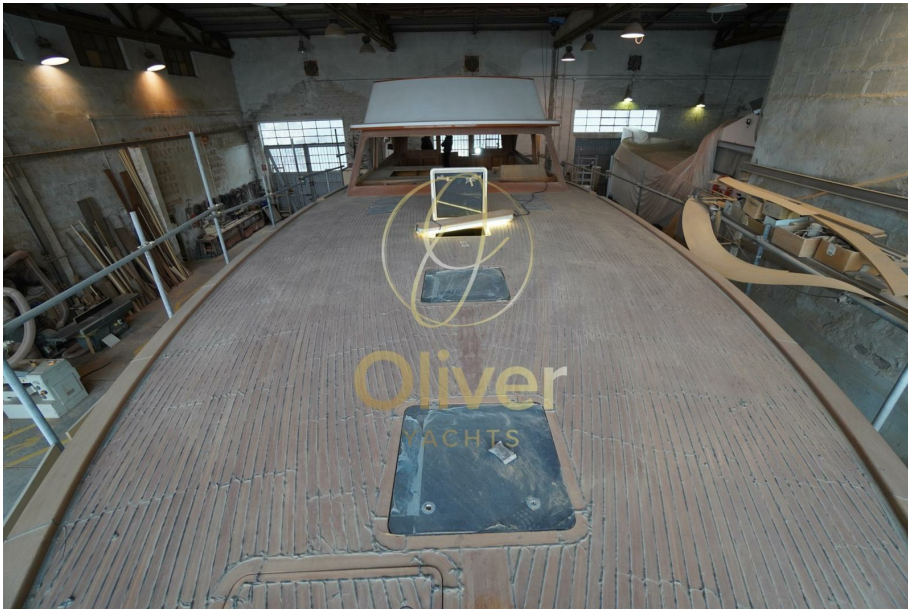



Oliver

YACHTS

ceccarelli

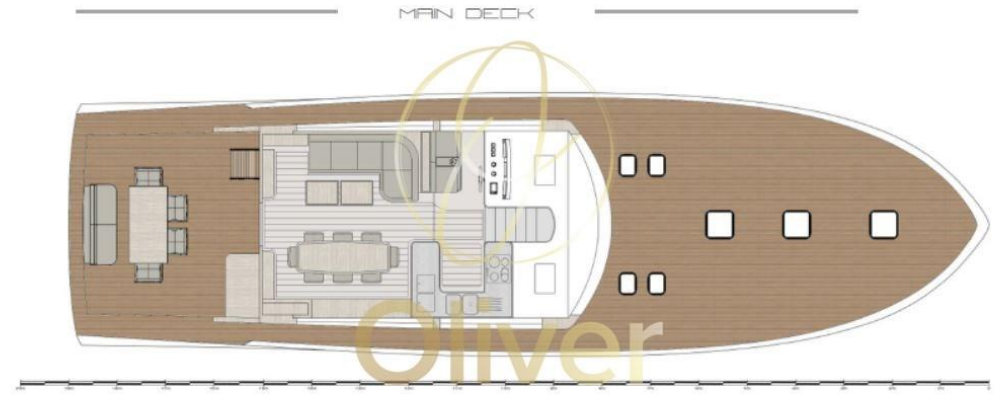

Oliver

YACHTS

ceccarelli

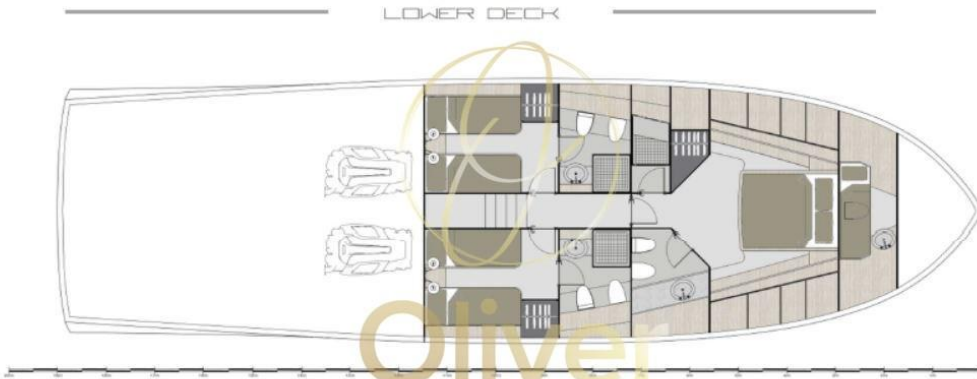

Oliver

YACHTS

ceccarelli

De Cesari

De Cesari

De Cesari