



SALE PRE OWNED

sunseeker Predator 62

640 000 € All Tax Included

Description

Company Disclaimer

Equipe Marine srl publishes the details of this boat in good faith and cannot guarantee or guarantee the accuracy of the information nor, expressly or implicitly, guarantee the condition of the boat. Every potential buyer should be aware that the "model year" varies from builder to builder and does not necessarily correspond to the year the boat was built. The offer of this boat is subject to sale, price change, or withdrawal without notice. This information can be viewed in various languages; however, the interpretation of the language that prevails must always be Italian.

Navigation equipment:

Rudder angle indicator, Radar Antenna, Electronic engine control, On-Board Computer, Autopilot (Raymarine), Plotter with GPS antenna (Raymarine), Radar (Raymarine), Co-pilot seat.

Staging and technical:

Engine Alarm, Bilge Alarm, Batteries (new 2023), Special Colour (black hull), Deck Shower, Stern Thruster (new 2023), Electric Flaps, Courtesy Lights, Underwater lights, Gangway (Besenzoni), Platform (up & down), Automatic Bilge Pump, Entry door, Teak Cockpit, Shorepower connector, Water harbor connector system, Electric Windlass, swimming ladder, cockpit table (teak), guard rails with gates.

Domestic Facilities onboard:

BBQ/Grill, Warm Water System, Safe, Inverter, Air Conditioning, Interior wooden

Specifications

YEAR

2007

WIDTH

5.00

FUEL TANK CAPACITY

3000

CABINS

3

ENGINE MANUFACTURER

MAN 1100

HORSE POWER

2 X 1100 CV

LENGTH

19.10

DRAFT

1.54

GUESTS CRUISING

14

BATHROOMS

1

ENGINE HOURS

1255

General

TYPE	BRAND	MODEL	GUESTS CRUISING
Motorboat	sunseeker	Predator 62	14

Dimensions / Performance

WEIGHT (T)	FUEL CAPACITY (L)	CRUISING SPEED (ND)	TOP SPEED (ND)
29.00	3000	28	33

Building / facilities

HULL MATERIAL	HULL COLOR	SUPER STRUCTURE MATERIAL	DECK MATERIAL
Vetroresina	-	Vetroresina	Vetroresina antisdrucchiolo
AMOUNT OF CABINS	BERTHS	BATHROOM(S)	
3	6	1	

Engine room

ENGINE	NUMBER OF ENGINES HORSE POWER (CV)	ENGINE HOURS	FUEL
MAN 1100	2 x 1100	1255	Diesel
STERN THRUSTER	BOW THRUSTER		

Electricity / air conditioning

ENGINE BATTERY	BATTERY CHARGER	GENERATOR	AIR CONDITIONING







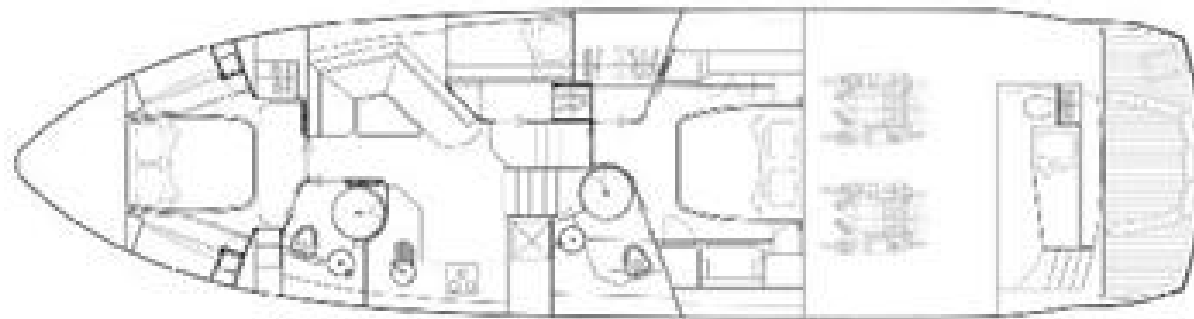

Sunseeker Predator 62

Photo