



SALE PRE OWNED

**solare Solare 40 ht classic**

**178 000 € All Tax Included**

## Description

Stunning... a "SOLAR" boat !! A modern... HARD TOP... inserted on the body of a CLASSIC LOBSTER... simply this!!

Version with external dinette closing door and elongated stern platform.

VERY GOOD CONDITION.

Complete repainting of deckhouse and sides 2021

Aquastop preventive anti-osmosis treatment in hull 2021

Walkways and stern platform in solid teack 2021

Satin teak wood parquet in the outdoor dinette

----Data considered correct, but not contractual. This does not constitute, in any case, a contractual document

The price displayed is net of our commissions, to be considered separate and additional

Navigation equipment:

Rudder angle indicator, Radar Antenna (Garmin), Depth Sounder (Garmin Fisch Finder), Plotter with GPS antenna (GPSMAP Garmin 1222xsv Touch - Multifunzione: Radar - Eco Fish Finder), VHF Radio (Icom IC-M411).

Staging and technical:

Water pressure pump, Teak Side Decks (Nuovi 2021), Battery charger (Quik), Special Colour (Fiancate Celeste) Deck Shower Row Thruster (Lewmar)

## Specifications

YEAR

**2004**

WIDTH

**4.00**

FUEL TANK CAPACITY

**1200**

CABINS

**2**

ENGINE MANUFACTURER

**Yanmar 6LJA STP**

HORSE POWER

**2 X 370 CV**

LENGTH

**11.40**

DRAFT

**1.00**

GUESTS CRUISING

**12**

BATHROOMS

**1**

ENGINE HOURS

**900**

## General

TYPE	BRAND	MODEL	GUESTS CRUISING
Motorboat	solare	Solare 40 ht classic	12
CURRENT LOCATION			
Showroom blue star corporation adriatico, veneto			

## Dimensions / Performance

WEIGHT (T)	FUEL CAPACITY (L)	CRUISING SPEED (ND)	TOP SPEED (ND)
9.90	1200	22	28

## Building / facilities

HULL MATERIAL	SUPER STRUCTURE MATERIAL	DECK MATERIAL	AMOUNT OF CABINS
Vetroresina	Vetroresina	Vetroresina	2
BERTHS	BATHROOM(S)		
6	1		

## Engine room

ENGINE	NUMBER OF ENGINES HORSE POWER (CV)	ENGINE HOURS	PROPULSION
Yanmar 6LJA STP	2 x 370	900	4 pale fissa
FUEL	BOW THRUSTER		
Diesel			

**Electricity / air conditioning**

---

BATTERY  
CHARGER

GENERATOR

AIR CONDITIONING

**Navigation equipment**

---

VHF

NAVIGATION COMPASS

SONAR

**Galley / Laundry / Entertainment**

---

FRIDGE

DVD PLAYER

**Deck equipment**

---

DECK SHOWER

**Safety equipment / miscellaneous**

---

BILGE PUMP



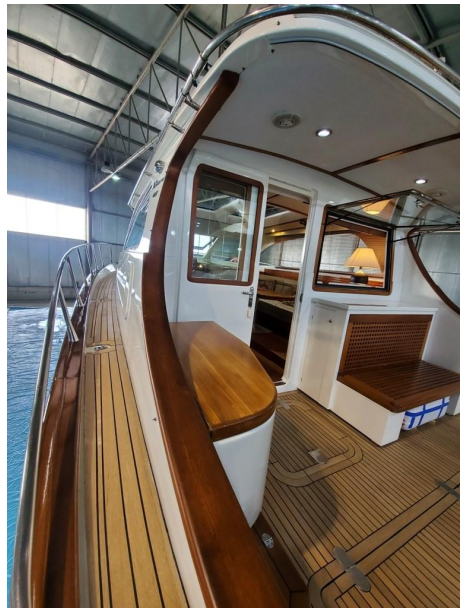











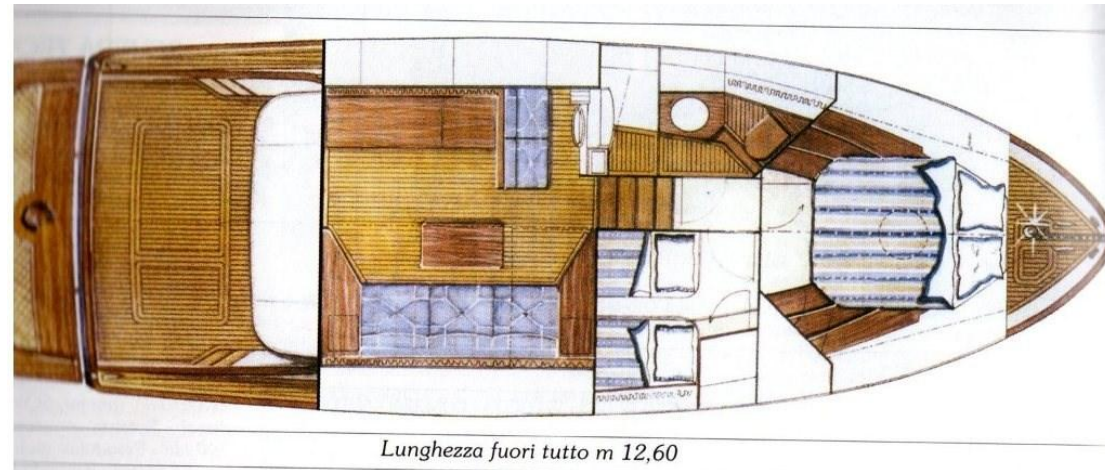

Lunghezza fuori tutto m 12,60

