



SALE PRE OWNED

princess F68

2 100 000 € + VAT

## Description

The Princess F68 is an exceptional motor yacht, combining elegance, performance and luxurious comfort. 1. Sophisticated, timeless design Modern lines: An elegant silhouette that combines aesthetics and aerodynamics. Top-of-the-range finishes: Meticulous attention to every detail, with luxurious materials such as fine woods, quality leathers and exclusive fabrics. 2. Luxurious space and comfort Spacious flybridge: Ideal for relaxing, entertaining or enjoying panoramic views. Equipped with flexible seating, a bar and a dining area. User-friendly cockpit: Perfect for alfresco dining, with direct access to the aft platform. Bright interior: Large windows flood the space with natural light, creating a perfect connection between inside and outside. 3. Exceptional marine performance Powerful engines: Powered by MAN V8 or Volvo IPS engines, for smooth, responsive sailing. Optimised stability: Fitted with gyroscopic or finned stabilisers for maximum comfort, even in rough seas. Advanced manoeuvrability: Intuitive controls and cutting-edge technology for easy manoeuvring in port. 4. State-of-the-art technology State-of-the-art electronics: Integrated instrument panels with touch screens, GPS, radar and advanced navigation systems. Connected systems: Equipment management via an app, allowing remote control of lights, air conditioning and audio system. 5. Exceptional habitability 4 luxurious cabins: A spacious owner's suite with en-suite bathroom, plus well-appointed guest cabins. Tailor-made accommodation: Customisation options to suit specific tastes and needs. Dedicated crew : Crew cabin option for discreet and professional service. 6. Leisure and entertainment Leisure options: Storage for jet-ski or dinghy, sunken aft platform, and plenty of space for

## Specifications

YEAR

2018

WIDTH

0.00

FUEL TANK CAPACITY

4100

ENGINE HOURS

975

LENGTH

21.25

DRAFT

2.82

CABINS

4

HORSE POWER

0 X 1400 CV

**General**

---

TYPE	BRAND	MODEL
motorboat	princess	F68

**Dimensions / Performance**

---

FUEL CAPACITY (L)	CRUISING SPEED (ND)	TOP SPEED (ND)
4100	25	36

**Building / facilities**

---

HULL MATERIAL	DECK MATERIAL	AMOUNT OF CABINS
Fiberglass	teak	4

**Engine room**

---

NUMBER OF ENGINES HORSE POWER (CV)	ENGINE HOURS	FUEL
0 x 1400	975	Diesel













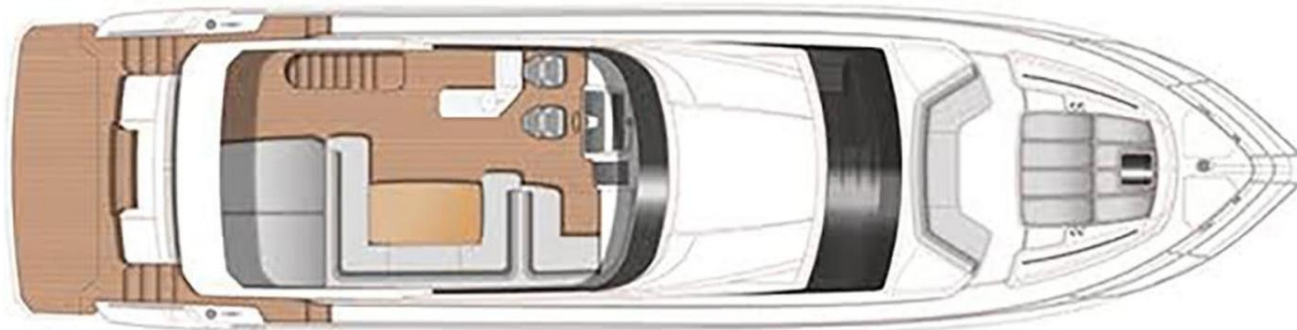

Flybridge

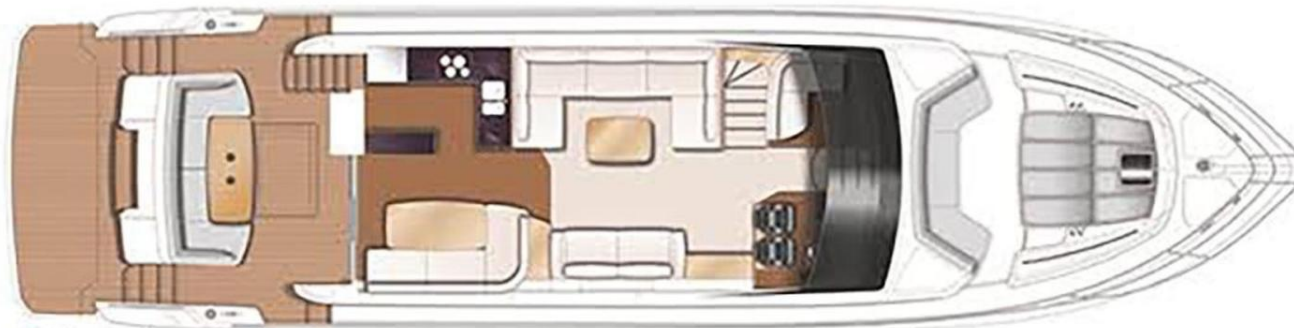

Main Deck

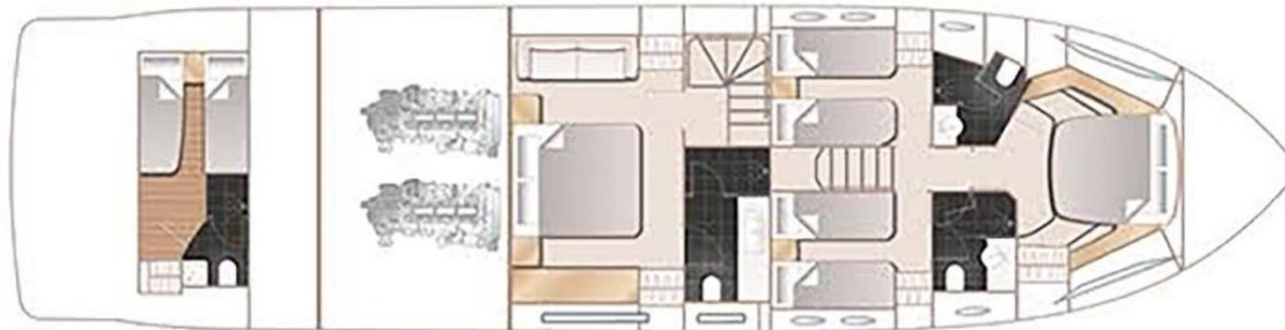

Lower Deck