



SALE NEW

neel-trimarans Neel 52

## Description

Length: 15.85 m Beam: 8.80 m Draft:1,90 m

Material: Polyester/composite

Displacement: 12 600,00 kg

Architect: Marc Lombard Yacht Design Group

Full batten mainsail (square top): 95.00 m<sup>2</sup> Genoa:71.00 m<sup>2</sup>

Engine: Volvo110,00 hp Fuel tank: 700,00 L

Water tank: 600,00 L

The NEEL 52 will seduce you with her modern and racy silhouette.

Life on board is mostly on one level, with an open-plan living space that offers an impressive living area. The cockloot® (interior/exterior living space specific to NEELs) is extremely large and is complemented by numerous seating options with different orientations called the Full Beam Cockpit®.

With natural interior light, the saloon also benefits from an exceptional 360° view to fully enjoy the landscapes, whether from the chart table, the kitchen or the saloon bench.

The refined interior design makes this space a soothing place to live.

The NEEL 52 is available in 2 versions:

\* all cabins in the hulls (possibility of 4 or 6 cabins)

## Specifications

YEAR

2024

WIDTH

8.80

FUEL TANK CAPACITY

700

GUESTS CRUISING

10

BATHROOMS

5

HORSE POWER

1 X 110 CV

LENGTH

15.85

DRAFT

1.90

FRESH WATER CAPACITY

600

CABINS

5

ENGINE MANUFACTURER

Volvo

**General**

---

TYPE	BRAND	MODEL	GUESTS CRUISING
multihull	neel-trimarans	Neel 52	10
CURRENT LOCATION			
La Rochelle			

**Dimensions / Performance**

---

FRESH WATER CAPACITY (L)	FUEL CAPACITY (L)
600	700

**Building / facilities**

---

AMOUNT OF CABINS	BERTHS	BATHROOM(S)
5	10	5

**Engine room**

---

ENGINE	NUMBER OF ENGINES HORSE POWER (CV)	ENGINE YEAR	FUEL
Volvo	1 x 110	2024	Diesel





























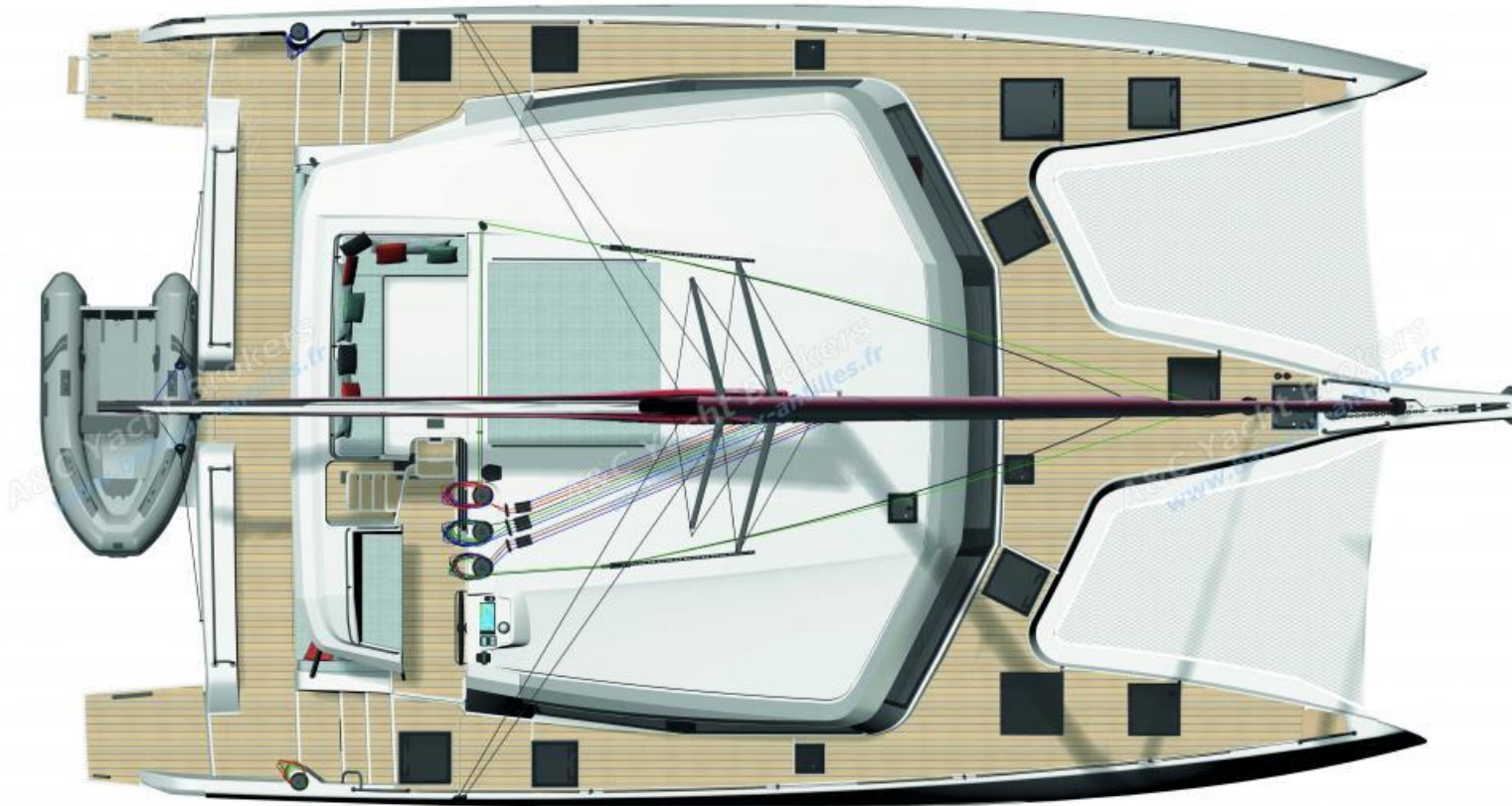

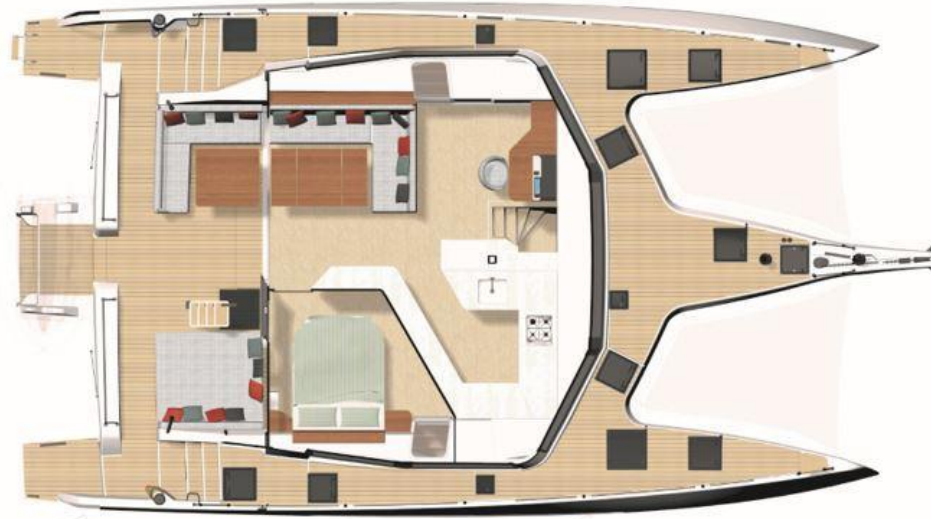

A&C Brokers  
www.bateaux-antilles.fr

A&C Yacht Brokers  
www.bateaux-antilles.fr

A&C Yacht  
www.bateaux-antilles.fr











