



SALE PRE OWNED

sunseeker Portofino 53

339 000 € ALL TAX INCLUDED

Description

Sunseeker Portofino 53, 2005.

Excellent overall condition - Ready for the 2026 season and numerous upgrades in 2024-2025.

Powered by a MAN 800 HP engine, approximately 850 hours.

Numerous accessories and upgrades: hull newly painted blue and garage door painted white (June 2025), electrically opening hardtop, new exterior cushions, new teak on the gangway grating, underwater lights, and air conditioning.

Forwardyachts is the appointed agent.

Navigation equipment:

AIS.

Staging and technical:

Underwater lights.

Domestic Facilities onboard:

Warm Water.

Entertainment:

Radio AM/FM, 3 TV.

Accessories notes:

Accessory Notes:

- Air conditioning
- Bow thruster
- Stern thruster
- GPS / Chartplotter
- Radar
- Autopilot

Specifications

YEAR

2005

WIDTH (M)

4.57

FUEL TANK CAPACITY (L)

1840

BATHROOMS

1

ENGINE HOURS

851

LENGTH (M)

17.35

DRAFT (M)

1.23

CABINS

3

ENGINE MANUFACTURER

MAN

HORSE POWER

2 X 800 HP

General

| | | | |
|-------------------|--------------------|-----------------------|----------------------------|
| Type motorboat | Brand sunseeker | Model Portofino 53 | Current Location Italia |
|-------------------|--------------------|-----------------------|----------------------------|

Dimensions/performance

| | | | |
|---------------------|---------------------------|------------------------------|-------------------------|
| Weight (T) 19.30 | Fuel Capacity (L) 1840 | Cruising Speed (Nd) 24.00 | Top Speed (Nd) 32.00 |
|---------------------|---------------------------|------------------------------|-------------------------|

Building/facilities

| | | | |
|------------------------------|---|-----------------------------------|-----------------------|
| Hull Material Vetroresina | Super Structure Material Vetroresina | Deck Material Teak+Vetroresina | Amount Of Cabins 3 |
| Berths 6 | Number Of Bathrooms 1 | | |

Engine Room

| | | | |
|----------------|------------------------|---------------------|------------------------------|
| Engine MAN | Horse Power 2x800CV | Engine Hours 851 | Propeller Type Pale fisse |
| Fuel Diesel | | | |

Electricity/air Conditioning

| | |
|-----------|------------------|
| Generator | Air Conditioning |
|-----------|------------------|

Navigation Equipment

GPS Radar VHF Navigation Compass

Galley/laundry/entertainment

Oven Microwave Freezer TV

Deck Equipment

Deck Shower











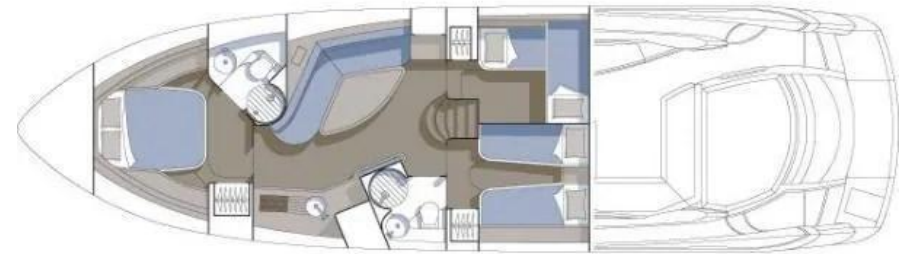

FORWARDYACHTS

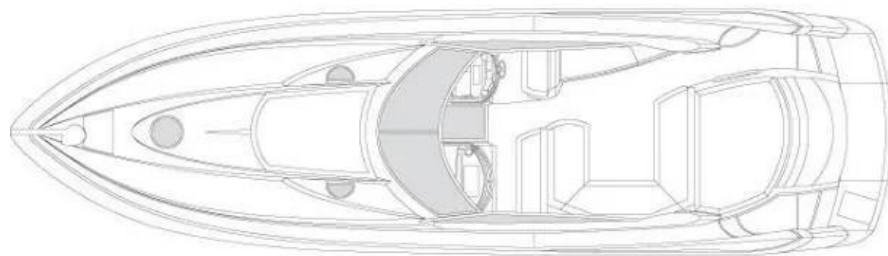

FORWARDYACHTS