

MOTORI

2022

SALE PRE OWNED

magnum marine Magnum 38 flash c 159 000 € ALL TAX INCLUDED

Specifications

YEAR
1980

LENGTH (M)
11.58

WIDTH (M)
3.70

FUEL TANK CAPACITY (L)
1500

GUESTS CRUISING
8

CABINS
1

BATHROOMS
1

ENGINE MANUFACTURER
Cummins I 6BTA 5.9.

HORSE POWER
2 X 375 HP

Description

Beautiful example of Magnum Marine 38 Flash Deck re-engined in 2022 with 2 Cummins Diesel of 375 hp, model 6BTA 5.9. MECHANICAL in-line V-drive axes!!

Some recent works:

2021- Solid teak cockpit renovation

2021- Teak structure for bow sundeck

2021 -replacement of axles and thrust bearings.

2021 - replacement of engine exhausts with ceramic steel products

2021 - Raymarine Gps

2022 - total dismantling of the engine room with restoration of spaces and systems.

2022 - Replacement of the engines with two new CUMMINS DIESEL model 6BTA 5.9 engines.

2022 - Replacement of diesel tanks with four new aluminum tanks

2022 - Replacement of water tank with new polypropylene tank.

2022 - Rudder coupling bar replacement and packing replacement

2022 - total renovation of the electrical system of the engine room

2022 - New roof driving area and cockpit, as well as two awnings one for the bow and one for the stern

2022 - Motor batteries

2024 - Utility Batteries (2 x 230 amp)

Navigation equipment:

Rudder angle indicator, GPS (Raymarine).

Staging and technical:

Anchor (acciaio inox), Spare shaft, Water pressure pump, 4 Batteries, Deck Shower, 2 Hydraulic Flaps, Platform, Automatic Bilge Pump, Entry door, Teak Cockpit (2021), Shorepower connector, Voltage Rectifier, Electric Windlass, swimming ladder, cockpit table, Living Room Foldable Table, Stern Winches.

Domestic Facilities onboard:

Warm Water System, 12V Outlets, 220V Outlets, Electric Toilet.

Entertainment:

Hi-Fi.

Kitchen and appliances:

Galley, Deck Refrigerator (a cassetto).

Upholstery:

Cushions, 3 Sunshade (prua, pozzetto e poppa).

General

Type motorboat	Brand magnum marine	Model Magnum 38 flash deck	Guests Cruising 8
Current Location Toscana			

Dimensions/performance

Weight (T) 12.00	Fuel Capacity (L) 1500	Cruising Speed (Nd) 22.00	Top Speed (Nd) 28.00
---------------------	---------------------------	------------------------------	-------------------------

Building/facilities

Hull Material Vetroresina	Super Structure Material Vetroresina	Deck Material Vetroresina	Amount Of Cabins 1
Berths 2	Number Of Bathrooms 1		

Engine Room

Engine CumminsI 6BTA 5.9.	Horse Power 2x375CV	Propeller Type 4 pale	Fuel Diesel
------------------------------	------------------------	--------------------------	----------------

Electricity

Engine Battery	Battery Charger	Generator	
----------------	-----------------	-----------	--

Navigation Equipment

GPS	VHF	Navigation Compass	Sonar
Speedometer	Anchor		

Galley/laundry/entertainment

Fridge

Deck Equipment

Deck Shower	Canopy
-------------	--------

Safety Equipment / Miscellaneous

Life Raft	Bilge Pump
-----------	------------





Magnum Marine Magnum 38 Flash Deck

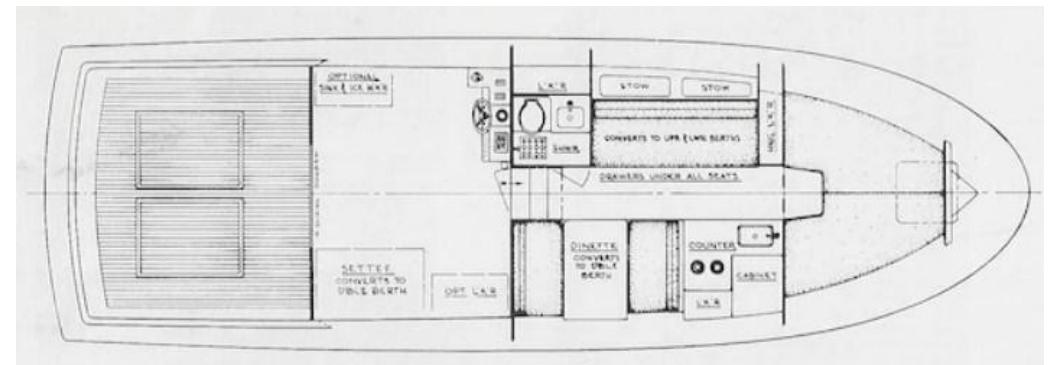



Magnum Marine Magnum 38 Flash Deck



