

VERSIONE SEI POSTI LETTO

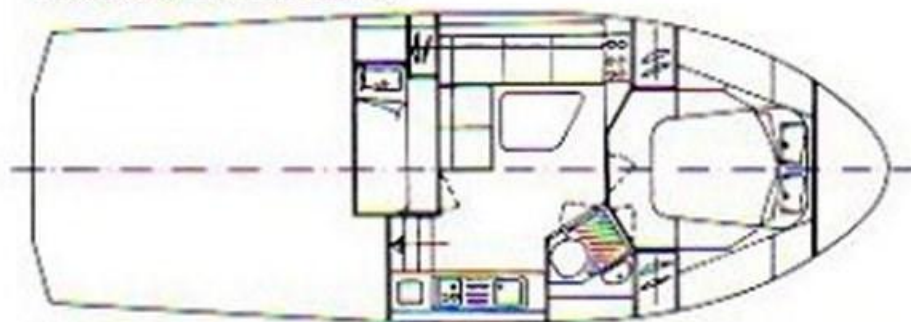

SALE PRE OWNED

azimut Az 38 open

57 000 € All Tax Included

Description

teak deck; 5% brokerage commission + 22% VAT to be paid by the buyer (VAT is calculated only on the amount of the commission)

Navigation equipment:

Rudder angle indicator, Depth Sounder (Furuno), GPS (Furuno), Chartplotter (Furuno).

Staging and technical:

Engine Alarm, Bilge Alarm, Water pressure pump, Batteries (3 x 200 a), Deck Shower, Hydraulic Flaps, Gangway (Idr. Besenzoni telec), Platform, 3 Automatic Bilge Pump, 2 Electric Bilge Pump, Manual Bilge Pump, Teak Cockpit, Rollbar, Electric Windlass (comando prua e plancia), swimming ladder, Outboard Engine Support Bracket, cockpit table (12 pers), Living Room Foldable Table, Tender (2 HP Yamaha).

Domestic Facilities onboard:

Warm Water System, Electric Toilet.

Security equipment:

Safety equipment within 50 miles, PFDs, Liferaft (10 p).

Entertainment:

Hi-Fi (Sony), TV (LG con decoder IPTV).

Fishing accessories:

Specifications

YEAR

1988

WIDTH

3.95

FUEL TANK CAPACITY

1000

CABINS

2

ENGINE MANUFACTURER

Cummins

HORSE POWER

2 X 250 CV

LENGTH

11.47

DRAFT

1.20

GUESTS CRUISING

12

BATHROOMS

1

ENGINE HOURS

1200

General

TYPE	BRAND	MODEL	GUESTS CRUISING
Motorboat	azimut	Az 38 open	12
CURRENT LOCATION			
Sicilia			

Dimensions / Performance

WEIGHT (T)	FUEL CAPACITY (L)	CRUISING SPEED (ND)	TOP SPEED (ND)
10.50	1000	20	26

Building / facilities

HULL MATERIAL	SUPER STRUCTURE MATERIAL	DECK MATERIAL	AMOUNT OF CABINS
Vetroresina	Vetroresina	TEAK	2
BERTHS	BATHROOM(S)		
6	1		

Engine room

ENGINE	NUMBER OF ENGINES HORSE POWER (CV)	ENGINE HOURS	FUEL
Cummins	2 x 250	1200	Diesel

Electricity / air conditioning

ENGINE BATTERY	BATTERY CHARGER	GENERATOR	HEATING SYSTEM
----------------	-----------------	-----------	----------------

Navigation equipment

GPS	TRACER	RADAR	VHF
NAVIGATION COMPASS	SONAR	SPEEDOMETER	

Galley / Laundry / Entertainment

MICROWAVE	FRIDGE	TV
-----------	--------	----

Deck equipment

DECK SHOWER	BIMINI	CANOPY
-------------	--------	--------

Safety equipment / miscellaneous

LIFE RAFT	BILGE PUMP
--------------	------------